

2019 Asphalt

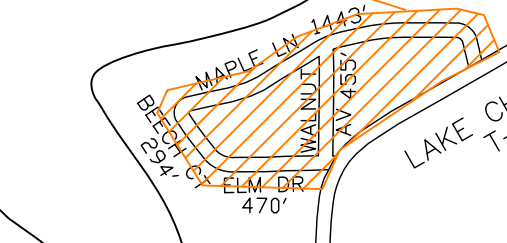

CONNECT WITH MAIN PLAT AT POINTS C & D

T. 6 S.  
R. 18 W.

19

20

21

25

30

29

28

31

32

33

R. 17 W.

LEGEND

- INTERSTATE HIGHWAY
- STATE HIGHWAY
- COUNTY ROAD; PRIMARY SYSTEM
- COUNTY ROAD; LOCAL SYSTEM
- PRIVATE ROAD
- PUBLIC ROAD (NOT OPEN)
- ADJACENT COUNTY ROAD
- RAILROADS

ROAD PROJECTS

- |  |                |  |                |
|--|----------------|--|----------------|
|  | 2012 SEAL COAT |  | 2018 SEAL COAT |
|  | 2013 SEAL COAT |  | 2019 SEAL COAT |
|  | 2014 SEAL COAT |  | 2020 SEAL COAT |
|  | 2015 SEAL COAT |  | 2021 SEAL COAT |
|  | 2016 SEAL COAT |  | 2022 SEAL COAT |
|  | 2017 SEAL COAT |  | OTHER PROJECT  |

Note: This map does not include Primary Road projects

LOCAL ROAD SYSTEM TOTAL FEET 26,847 EQUALS 5.08 MILES

BERRIEN TOWNSHIP

BERRIEN COUNTY ROAD DEPARTMENT  
BENTON HARBOR, MICHIGAN

KEVIN STACK, COUNTY HWY ENGINEER

SCALE: 1"=800' DATE: November, 2022

No. 4 C

