

FLUSHING YOUR HOUSE PLUMBING SYSTEM WHEN WATER SERVICES ARE RESTORED

Guidance

When water service is turned back on, it is important to flush the plumbing in your home. Moving fresh water through your pipes flushes bacteria and metals from your plumbing. These instructions provide step-by-step instructions on how to completely flush your home plumbing. If you have difficulty following these steps, contact a licensed plumber for assistance.

STEP-BY-STEP INSTRUCTIONS

Complete these steps in the order below. Finish each step completely before moving to the next step.

Before starting the steps below:

- Turn off the supply valve to your water heater, if possible.
- Bypass water softeners and/or whole house filters if you have them.

Discoloration may occur during flushing. This is expected.

1. Locate the faucets to be flushed and make sure the drains are open.

- Don't forget faucets in the basement or other floors of your house.
- Remove or bypass all fixture filters. You should not flush through a filter.

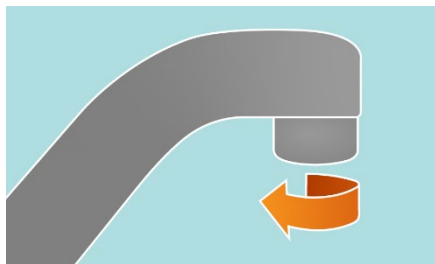
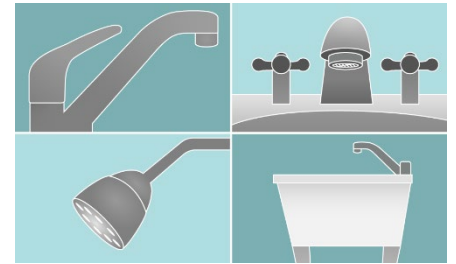

2. Remove aerators and screens from faucets and shower heads.

Unscrew the aerators as shown. See guidance below about removing and cleaning your aerators.

3. Open all cold water taps. Leave all faucets running during this process.

- First open faucets in the basement or lowest floor in the house.
- Then open faucets on the next highest floor of the house.
- Continue until all faucets are open on all floors, including tubs and showers (remove shower head if possible).

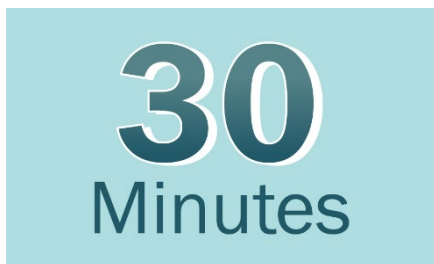
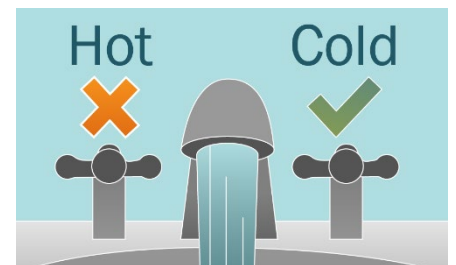

4. Leave ALL faucets running for at least 30 minutes.

5. Turn off the 1st faucet you turned on (basement or lowest floor).

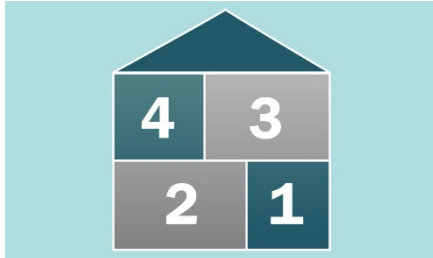
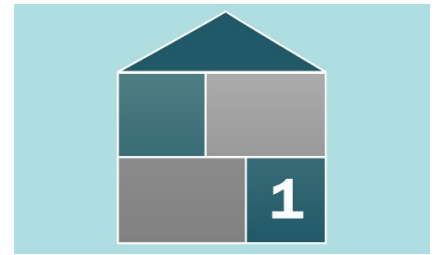

6. Turn off all other faucets in the same order you turned them on.

7. Turn on each kitchen or bathroom tap, one at a time, and run each for 10 minutes or more. Make sure only one tap is running at a time.

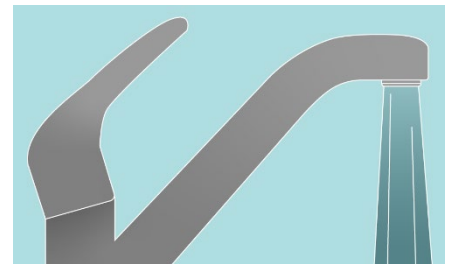

8. Clean and re-install aerators and screens on each faucet and shower head.

- See pages below for guidance on cleaning aerators and screens.
- You may need to replace aerators/screens if they are too old or worn.

After completing these steps, remember to re-open the supply valve to your water heater. It is recommended that water heaters be flushed at this time.

DO NOT use hot water for drinking, cooking or preparing baby formula.