



# Berrien County Road Department

2860 E. Napier Avenue  
Benton Harbor, MI 49022

Phone: 269-925-1196  
Fax: 269-925-8098  
www.bcroad.org

**FOR IMMEDIATE RELEASE**

**MONDAY, MARCH 1st, 2021**

**CONTACT:** Adri Boone – Berrien County Road Department Administrative Assistant  
aboone@bcroad.org – 269-925-1196 ext. 4410

## BAILEY ROAD CLOSURE

**TOWNSHIP:** Pipestone Township

**LOCATION:** Bailey Road, north of Sinclair Road

**CLOSEST CITIES:** Eau Claire

**START DATE:** 10am Monday, 3/1/2021

**ESTIMATED END DATE:** Friday, 3/5/2021\*

\*Weather, work and contractor dependent

**PROJECT:** A contractor doing work to the Zech Drain for the Drain Commission will have Bailey Road closed to complete culvert replacement work.

**SAFETY BENEFITS:** This project will extend the life and operation of the Zech Drain. Crosstube replacement will provide structural stability to the road and assure safety to the traveling public.

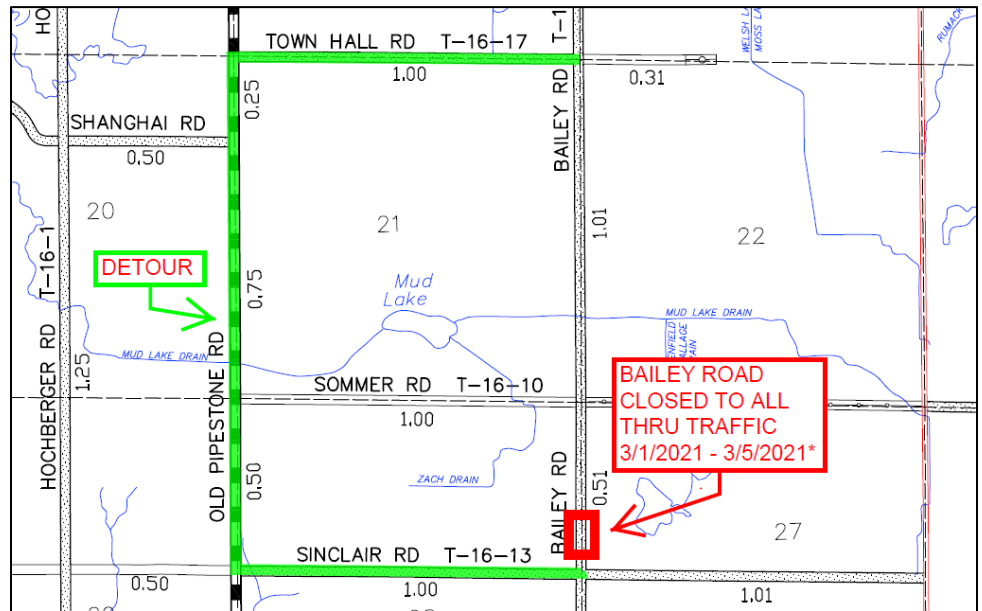

**TRAFFIC RESTRICTIONS:** Bailey Road will be closed to thru traffic at the Zech Drain. The drain is located just north of the Sinclair Road intersection. Closure will begin the approximately 10am, 3/1/2021. Work is anticipated to being completed by the end of the week. Please seek alternative routes or use the recommended detour route until work is completed.

**DETOUR ROUTE:** The recommended detour route will be Sinclair Road to Old Pipestone Road to Town Hall Road.

###